

**IRC916-E Cut Sheet**

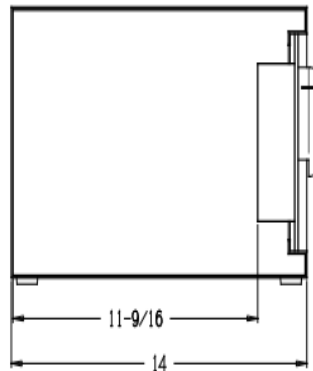

BACK VIEW



SECTION VIEW

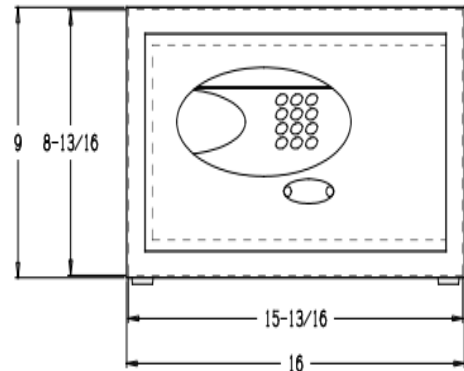

FRONT VIEW

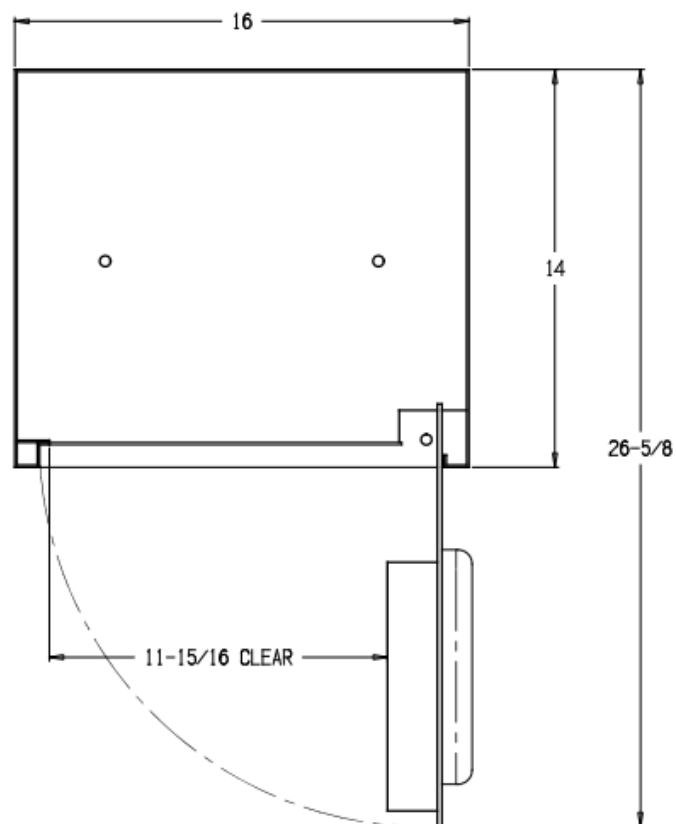



#### SPECIFICATIONS

1. Safe, 9 H x 16 W x 14 D, Outside.
2. Chest, 8-13/16 H x 15-13/16 W x 11-9/16 D, Inside. Constructed of 14 Ga. Steel.
3. Door, Clear Opening: 6-1/2 H x 11-15/16 W, Constructed of 5mm Steel. Equipped with an Electronic Credit Card Lock and Key Lock Override System, with Two (2) Chrome-Plated Steel Locking Bolts.
4. Provided with Four (4) Anchor Holes with Hardware. Equipped with Four Removable Foot Pads.
5. 0.97 cu.ft. (1672 cu.in.) Capacity.
6. Approx. Weight: 29 lbs.

